

John Redman

next page

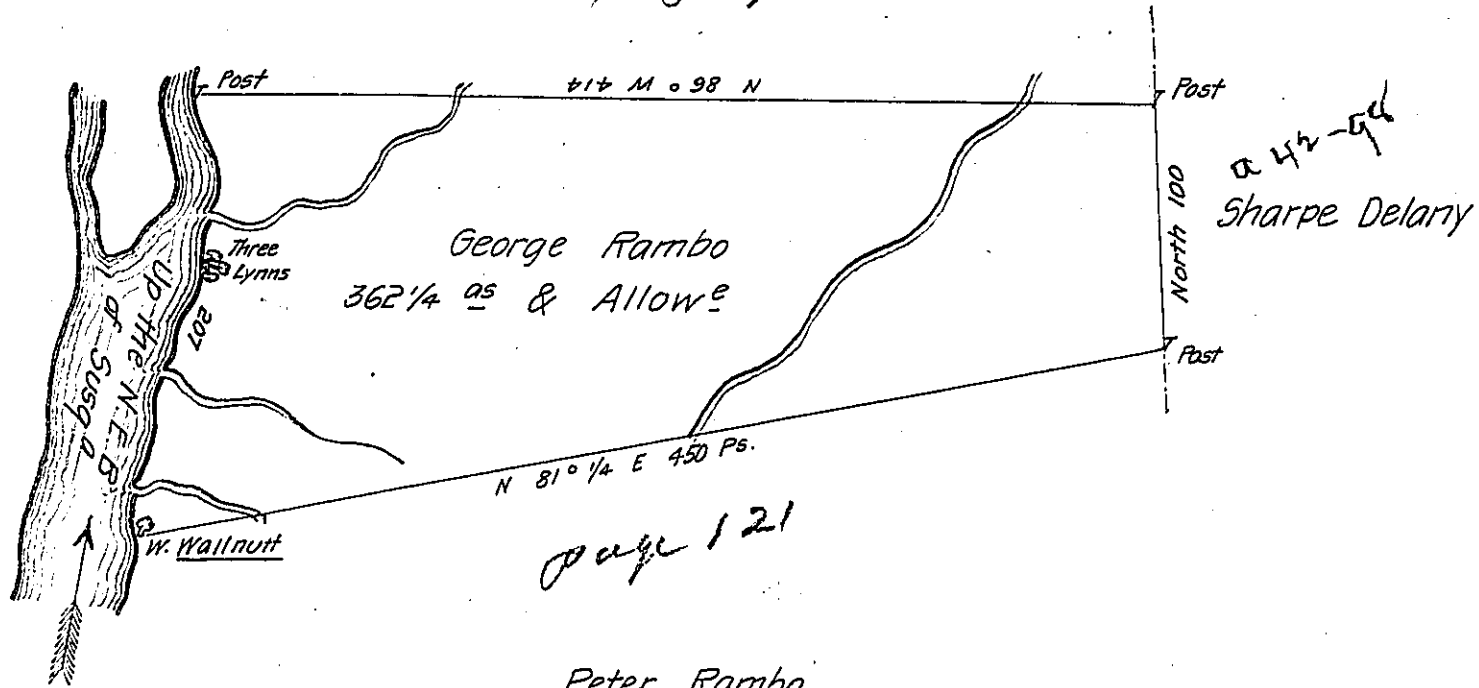

Peter Rambo

Draught of a tract of land Called—Situat in the Great Bend join-  
 ing Land surveyed for John Redman & others in Northumberland County County  
 Containing three hundred sixty two acres 1/4 & allowance of Six P. Cent for Roads  
 &c. Surveyed for George Rambo the 23<sup>d</sup> day of May 1785 in pursuance of a war-  
 rant dated the 4<sup>th</sup> day of April 1785

by

W<sup>m</sup> Gray D.S.

To John Lukens Esq<sup>r</sup>

Surv<sup>r</sup> Gen<sup>l</sup>.

IN TESTIMONY that the above is a copy of the original remaining on file in  
 the Department of Internal Affairs of Pennsylvania, made  
 conformably to an Act of Assembly approved the 16th day of  
 February, 1833, I have hereunto set my Hand and caused  
 the Seal of said Department to be affixed at Harrisburg,  
 this twenty first day of September 1906

*Isaac R. Brown*  
 Secretary of Internal Affairs.